

ON-OFF-ON (contura II)

(VJD1-D66B body)

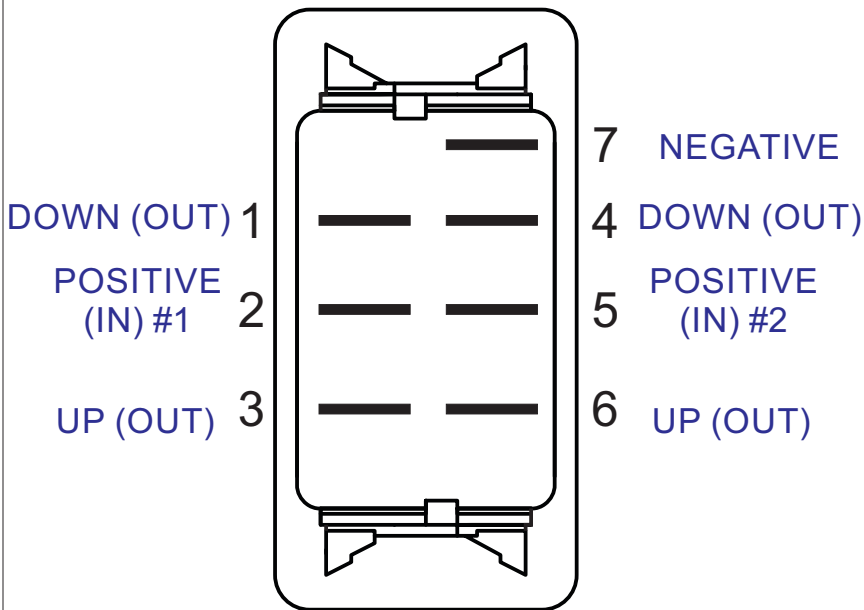

TERMINALS



LAMPS

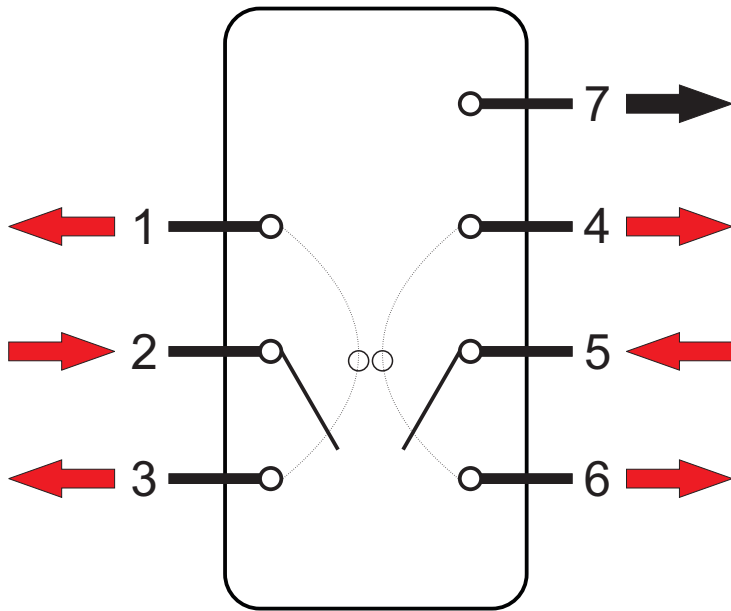
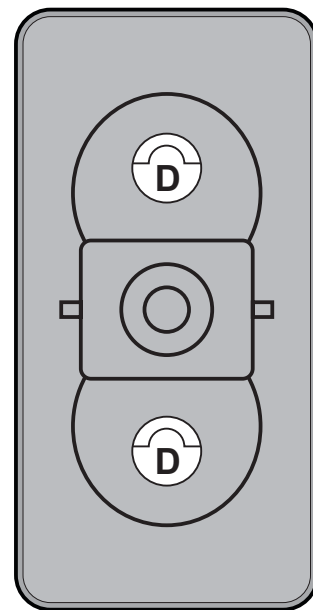

CIRCUIT
DIAGRAM

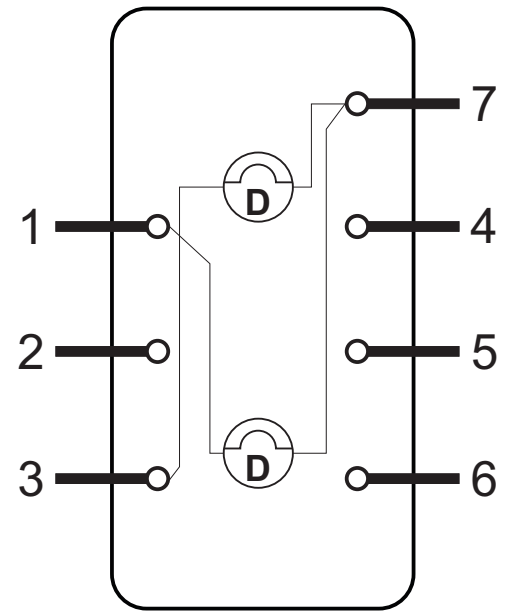

LAMP
DIAGRAM

www.NewWireMarine.com

- DEPENDENT LAMP
- INDEPENDENT LAMP
- (ON) MOMENTARY CIRCUIT
- MOMENTARY CIRCUIT

- LOAD CURRENT IN/OUT
- INDEPENDENT LAMP TRIGGER
- NEGATIVE RETURN CURRENT

KEY

Nav/Anc Wiring Diagram

(VJD1-D66B body)

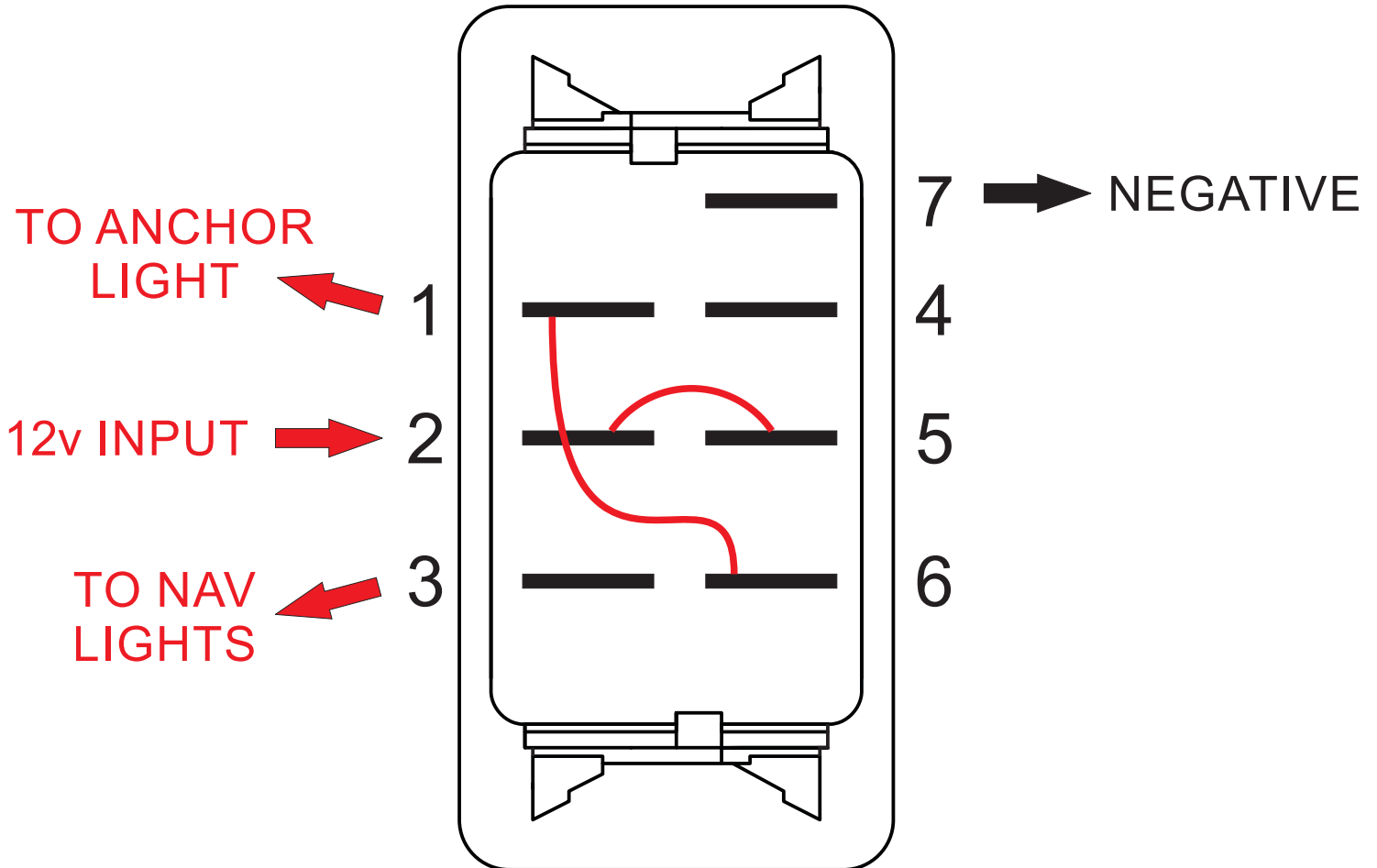

Two jumpers are required for Nav/Anc functionality:

- 1) terminals 2 - 5
- 2) terminals 1 - 6

Both lights will illuminate in up position, but only anchor lights will illuminate in down position